

EasyClean

Leak Return Port Body

Side Exit 40mm

Specifications



Flow rate 32-35 l/min
 Water seal 75mm
 Inlet size 90mm
 Outlet size 40mm
 (Solvent welds over 40mm and inside 50mm DWV pipe compliant with AS/NZS1260)

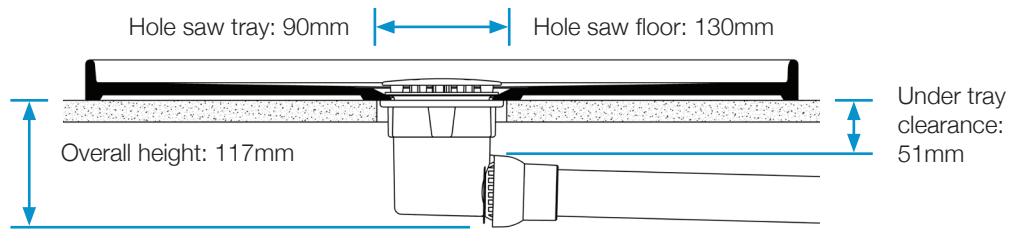

Product Codes



With Flat Lid

| | | |
|--|-------------|-------------------------------|
| | White | LRP FW ECW SE40 0120.01 |
| | Ivory | LRP FI ECW SE40 0120.02 |
| | Chrome | LRP FC ECW SE40 0120.03 |
| | Gold | LRP FG ECW SE40 0120.04 |
| | Matt Chrome | LRP FMC ECW SE40 0120.05 |



With Dome Lid

| | | |
|--|-------------|-------------------------------|
| | White | LRP DW ECW SE40 0120.11 |
| | Ivory | LRP DI ECW SE40 0120.12 |
| | Chrome | LRP DC ECW SE40 0120.13 |
| | Gold | LRP DG ECW SE40 0120.14 |
| | Matt Chrome | LRP DMC ECW SE40 ... 0120.15 |

Spare Parts Codes

All spare parts are NON-RETURNABLE, please ensure that correct part has been ordered

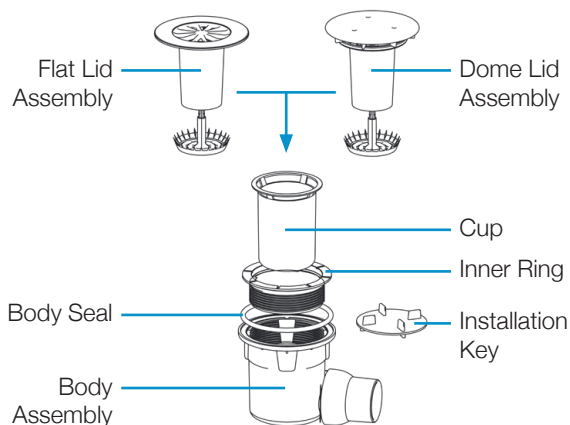

| | |
|---|----------|
| Lid Assembly EasyClean Flat White | 0180.01 |
| Lid Assembly EasyClean Flat Ivory | 0180.02 |
| Lid Assembly EasyClean Flat Chrome | 0180.03 |
| Lid Assembly EasyClean Flat Gold | 0180.04 |
| Lid Assembly EasyClean Flat Matt Chrome | 0180.05 |
| Lid Assembly EasyClean Dome White | 0180.11 |
| Lid Assembly EasyClean Dome Ivory | 0180.12 |
| Lid Assembly EasyClean Dome Chrome | 0180.13 |
| Lid Assembly EasyClean Dome Gold | 0180.14 |
| Lid Assembly EasyClean Dome Matt Chrome | 0180.15 |
| Inner Ring | 0200.226 |
| Body Seal | 0200.202 |
| Cup | 0200.228 |
| Body Assembly LRP SE40 | 0200.104 |
| Installation Key | 0200.229 |