

# HiFlow

Standard Body

Side Exit 40mm

## Specifications



Flow rate ..... 32-35 l/min  
 Water seal ..... None  
 Inlet size ..... 90mm  
 Outlet size ..... 40mm  
 (Solvent welds over 40mm and inside 50mm DWV pipe compliant with AS/NZS1260)



no water seal



standard body

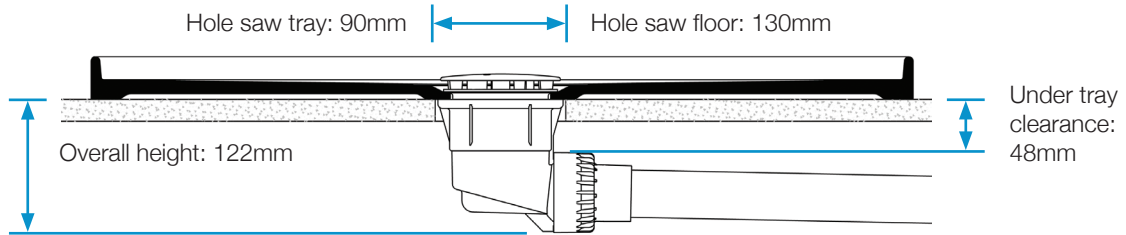

## Product Codes



With Flat Lid

	White	STD FW HF SE40	.....	0500.01
	Ivory	STD FI HF SE40	.....	0500.02
	Chrome	STD FC HF SE40	.....	0500.03
	Gold	STD FG HF SE40	.....	0500.04
	Matt Chrome	STD FMC HF SE40	.....	0500.05

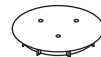

With Dome Lid

	White	STD DW HF SE40	.....	0500.11
	Ivory	STD DI HF SE40	.....	0500.12
	Chrome	STD DC HF SE40	.....	0500.13
	Gold	STD DG HF SE40	.....	0500.14
	Matt Chrome	STD DMC HF SE40	.....	0500.15

## Spare Parts Codes

All spare parts are NON-RETURNABLE, please ensure that correct part has been ordered

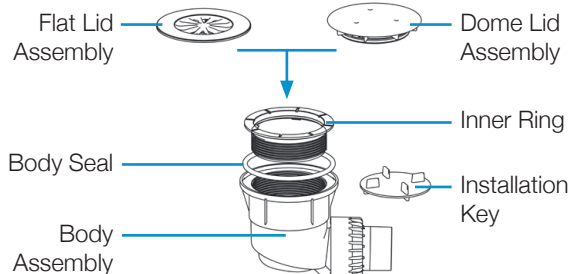

Lid Assembly HiFlow Flat White	.....	0580.01
Lid Assembly HiFlow Flat Ivory	.....	0580.02
Lid Assembly HiFlow Flat Chrome	.....	0580.03
Lid Assembly HiFlow Flat Gold	.....	0580.04
Lid Assembly HiFlow Flat Matt Chrome	.....	0580.05
Lid Assembly HiFlow Dome White	.....	0580.11
Lid Assembly HiFlow Dome Ivory	.....	0580.12
Lid Assembly HiFlow Dome Chrome	.....	0580.13
Lid Assembly HiFlow Dome Gold	.....	0580.14
Lid Assembly HiFlow Dome Matt Chrome	.....	0580.15
Inner Ring	.....	0200.226
Body Seal	.....	0200.202
Body Assembly STD SE40	.....	0200.102
Installation Key	.....	0200.229