

### Specifications

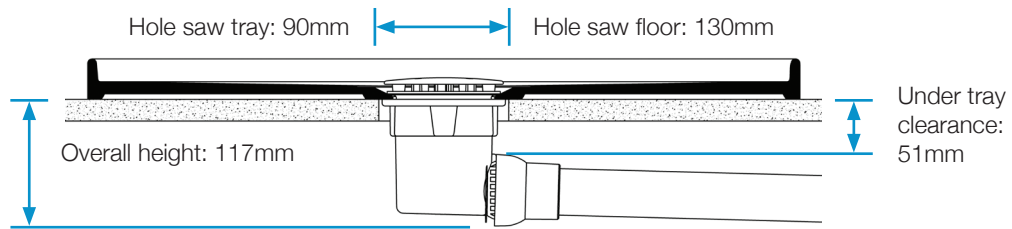

Flow rate ..... 33-44 l/min  
 Water seal ..... None  
 Inlet size ..... 90mm  
 Outlet size ..... 40mm  
 (Solvent welds over 40mm and inside 50mm DWV pipe compliant with AS/NZS1260)



### Product Codes



With Flat Lid

	White - LRP FW HF SE40 .....	0520.01
	Ivory - LRP FI HF SE40 .....	0520.02
	Chrome - LRP FC HF SE40 .....	0520.03
	Gold - LRP FG HF SE40 .....	0520.04
	Matt Chrome - LRP FMC HF SE40 .....	0520.05

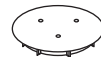

With Dome Lid

	White - LRP DW HF SE40 .....	0520.11
	Ivory - LRP DI HF SE40 .....	0520.12
	Chrome - LRP DC HF SE40 .....	0520.13
	Gold - LRP DG HF SE40 .....	0520.14
	Matt Chrome - LRP DMC HF SE40 .....	0520.15

### Spare Parts Codes

All spare parts are NON-RETURNABLE, please ensure that correct part has been ordered

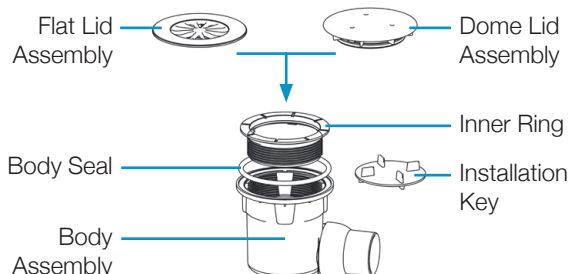

Lid Assembly HiFlow Flat White .....	0580.01
Lid Assembly HiFlow Flat Ivory .....	0580.02
Lid Assembly HiFlow Flat Chrome .....	0580.03
Lid Assembly HiFlow Flat Gold .....	0580.04
Lid Assembly HiFlow Flat Matt Chrome .....	0580.05
Lid Assembly HiFlow Dome White .....	0580.11
Lid Assembly HiFlow Dome Ivory .....	0580.12
Lid Assembly HiFlow Dome Chrome .....	0580.13
Lid Assembly HiFlow Dome Gold .....	0580.14
Lid Assembly HiFlow Dome Matt Chrome .....	0580.15
Inner Ring .....	0200.226
Body Seal .....	0200.202
Body Assembly LRP SE40 .....	0200.104
Installation Key .....	0200.229